



# LADL30-N SERIES

Convert new or existing fluorescent fixtures into emergency lighting units  
3000 lumen emergency ballast

TYPE \_\_\_\_\_

CATALOG # \_\_\_\_\_

NOTES \_\_\_\_\_

## FEATURES

### Housing

- Steel housing contains, battery, battery charger, transfer circuit and high frequency inverter
- Operating temperature 32°F to 122°F (0°C to 50°C)

### Mounting

- External mounting to a fluorescent fixture

### Lamp Type Operation (refer to Ballast/Lamp Reference Chart for specific lamp type)

- Compatible with most one-, two-, three-, and four-lamp electronic standard and dimming AC ballast
- Operates two 8W-54W T5/T5HO, two 17W-40W, one 17W-215W T8 through T12, two 13W-42W 4-pin compact, two 18W-50W or one 18W-55W 4-pin long compact fluorescent lamps

### Lumen Output

- (1) Lamp 825-3000 Lumens
- (2) Lamps 900-3000 Lumens per lamp

### Electronics

- Can be wired to operate switched, un-switched or normally off fixtures without affecting normal operation
- Will cold start and illuminate lamps
- Fully Automatic solid state charger
- High capacity, automatic, dust-tight instantaneous transfer relay
- Low voltage disconnect prevents over discharge of battery
- Automatic brownout protection
- Battery connector prevents battery discharge during installation

### Controls

- Red charger monitor LED indicates charging of the battery and AC present
- Momentary test switch allows for quick operational check of entire system

### Sealed Maintenance-Free Battery

- Nickel-Cadmium battery
- Provides 90 minutes of emergency operation

### Power Requirements

- Dual voltage 120/277VAC, 60Hz, 5.1W

### Approvals

- UL 924 Standards
- Damp location listed

### Warranty (subject to proper installation and maintenance)

- Ballast has a five year full warranty

### ACCESSORIES (order as separate item)

Remote Test Switch (Metal faceplate)	<b>PSW</b>
Remote Test Switch (Plastic faceplate)	<b>PSW1</b>
Recommended for inaccessible locations. Test switch and charging indicator on a single mounting plate.	
Replacement Test Switch	<b>TBTSBA-L</b>

## ORDERING FORMAT

SERIES	OPTIONS
LADL30-N	<b>Blank</b> = Standard Unit <b>-DL</b> = Damp location Listed

EXAMPLE: LADL30-N

## SPECIFICATIONS

Supply and install Lightalarms® LADL30-N Series.

The LADL30-N fluorescent emergency ballast shall be a single steel housing self-contained unit including a sealed maintenance-free Nickel-Cadmium battery, battery charger, transfer circuit and high frequency inverter. The unit shall be rated 120/277VAC, 60 Hz and be UL924 listed.

The LADL30-N fluorescent emergency ballast, sealed dust-tight relay inverter charger transfer circuit shall be of a solid state design being automatic and instantaneous capable of supplying an initial 3000 lumens output to cold start, operate switched, un-switched or normally off fixtures without affecting normal operation. The battery shall supply emergency operation for a minimum of 90 minutes and shall be capable of full recharge in compliance with UL924 specifications.

The unit shall be furnished with, red charger monitor LED indicates charging of the battery and AC present to unit as well as a momentary test switch allows for quick operational check of entire system.

Every LADL30-N Series unit shall be fully warranted for five years, subject to proper installation and maintenance. UL listed to standard 924, complies with NEC, Life Safety Code and OSHA requirements.

Unit shall be Lightalarms® catalog number \_\_\_\_\_.

## DIMENSIONS

Dimensions are approximate and subject to change.

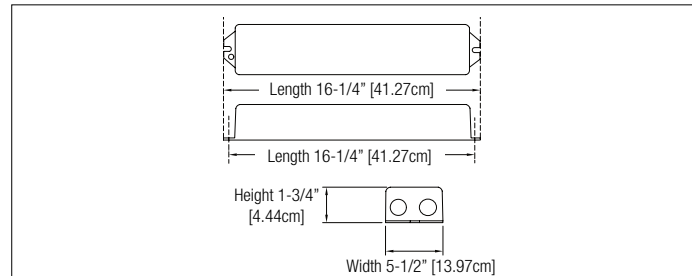

## COMPATIBLE LAMP CHART

LAMP	VOLTAGE	WATTAGE	INITIAL LUMENS	
			1-LAMP	2-LAMPS
T5	120/277V	14W	1150	1200
T5		21W	1750	1800
T5		28W	2350	2425
T5HO		39W	2700	2850
T5HO		54W	2900	3000
T8		17W	1100	1150
T8		32W	2950	3000
T12		20W	875	900
T12		40W	2250	2400
T8		59W	2800	-
T12		110W	2950	-
T12		215W	3000	-
4-pin PL CF		13W	825	900
4-pin PL CF		18W	1100	1200
4-pin PL CF		26W	1500	1600
4-pin PL CF		32W	2200	2300
4-pin PL CF	42W	2450	2500	
4-pin Long CF	18W	1250	1400	
4-pin Long CF	24W	1750	1900	
4-pin Long CF	36W	2200	2300	
4-pin Long CF	40W	2350	2400	
4-pin Long CF	50W	2250	2400	
4-pin Long CF	55W	2500	-	