



TYPE \_\_\_\_\_

CATALOG # \_\_\_\_\_

NOTES \_\_\_\_\_

## LADL12 SERIES

Convert new or existing fluorescent fixtures into emergency lighting units  
1350 lumen emergency ballast



### FEATURES

#### Housing

- Steel housing contains, battery, battery charger, transfer circuit and high frequency inverter
- Optional end caps available
- Operating temperature 68°F to 122°F (20°C to 50°C)

#### Mounting

- Internal or external mounting to a fluorescent fixture

#### Lamp Type Operation (refer to Ballast/Lamp Reference Chart for specific lamp type)

- One 14-54W or two 14-39W
- (2'-4') T5 and T8 lamps with instant start or rapid start or one 4-pin
- 18-50W long compact fluorescent or one 4-pin
- 32W compact fluorescent or one 24-32W U-Bend lamp

#### Lumen Output

- (1) Lamp 800-1350 Lumens
- (2) Lamps 850-1300 Lumens

#### Electronics

- Can be wired to operate switched, un-switched or normally off fixtures without affecting normal operation
- Will cold start and illuminate lamps
- Fully Automatic solid state charger
- High capacity, automatic, dust-tight instantaneous transfer relay
- Low voltage disconnect prevents over discharge of battery
- Automatic brownout protection
- Battery connector prevents battery discharge during installation

#### Controls

- Red charger monitor LED indicates charging of the battery and AC present
- Momentary test switch allows for quick operational check of entire system

#### Sealed Maintenance-Free Battery

- Nickel-Cadmium battery
- Provides 90 minutes of emergency operation

#### Power Requirements

- Dual voltage 120/277VAC, 60Hz, 3.7W

#### Approvals

- UL 924 Standards
- Damp location listed

#### Warranty (subject to proper installation and maintenance)

- Ballast has a five year full warranty

#### ACCESSORIES (order as separate item)

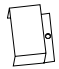
	External mounting kit includes wire bundle cover	<b>EC6</b>
	Remote Test Switch (Metal faceplate)	<b>PSW</b>
	Remote Test Switch (Plastic faceplate)	<b>PSW1</b>
	Recommended for inaccessible locations. Test switch and charging indicator on a single mounting plate.	Charging Indicator Light Push Button Test Switch
	Replacement Test Switch	<b>TBTSP-L</b>

#### ORDERING FORMAT

<b>SERIES</b>
<b>LADL12</b>

EXAMPLE: LADL12

### SPECIFICATIONS

Supply and install **Lightalarms® LADL12 Series**.

The **LADL12** fluorescent emergency ballast shall be a single steel housing self-contained unit including a sealed maintenance-free Nickel-Cadmium battery, battery charger, transfer circuit and high frequency inverter. The unit shall be rated 120/277VAC, 60 Hz and be UL924 listed.

The **LADL12** fluorescent emergency ballast, sealed dust-tight relay inverter charger transfer circuit shall be of a solid state design being automatic and instantaneous capable of supplying an initial 1350 lumens output to cold start, operate switched, un-switched or normally off fixtures without affecting normal operation. The battery shall supply emergency operation for a minimum of 90 minutes and shall be capable of full recharge in compliance with UL924 specifications.

The unit shall be furnished with, red charger monitor LED indicates charging of the battery and AC present to unit as well as a momentary test switch allows for quick operational check of entire system.

Every **LADL12 Series** unit shall be fully warranted for five years, subject to proper installation and maintenance. UL listed to standard 924, complies with NEC, Life Safety Code and OSHA requirements.

Unit shall be **Lightalarms®** catalog number \_\_\_\_\_.

### DIMENSIONS

Dimensions are approximate and subject to change.

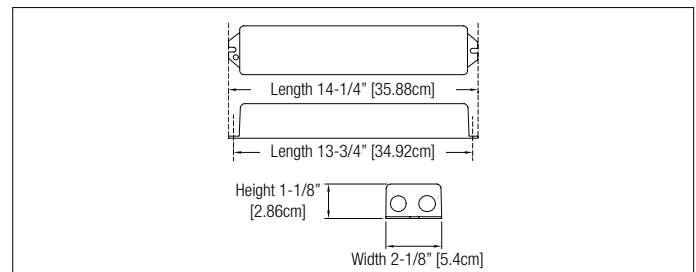

### COMPATIBLE LAMP CHART

LAMP	VOLTAGE	WATTAGE	INITIAL LUMENS	
			1-LAMP	2-LAMP
F14W T5	120/277V	14	880	850
F21W T5		21	1000	960
F24W T5/HO		24	1250	1210
F28W T5		28	1300	1250
F39W T5/HO		39	1200	1130
F54W T5/HO		54	1150	-
F14W T8		14	900	850
F20W T8		20	1150	1120
F28W T8		28	1200	1180
F32W T8		32	1350	1300
F36W T8		36	1200	1150
F39W T8		39	1150	1100
F54W T8		54	1100	-
F32W PLCF Quad 4pin		32	1100	1050
PLC F36W	36	1050	1000	
PLC F40W	40	1100	-	
PLC F50W	50	1000	-	
PLC F30BX, 40BX, 50BX	30, 40, 50	1300	-	
F24W U-BEND FBT8	24	1050	1000	
F32W U-BEND FBT8	32	1150	1100	