

X4 Steel Series - Self Powered LED Exits

IMPORTANT SAFEGUARDS

When using electrical equipment, basic safety precautions should always be followed including the following:

READ AND FOLLOW ALL SAFETY INSTRUCTIONS

1. Do not use outdoors.
2. Do not let power supply cords touch hot surfaces.
3. Do not mount near gas or electric heaters.
4. Use caution when handling batteries. Avoid possible shorting.
5. Equipment should be mounted in locations and at heights where it will not readily be subjected to tampering by unauthorized personnel.
6. The use of accessory equipment not recommended by the manufacturer may cause an unsafe condition.
7. Do not use this equipment for other than intended use.
8. All servicing should be performed by qualified service personnel.

SAVE THESE INSTRUCTIONS

Installation Instructions

1. Turn off AC power.
2. Route AC unswitched circuit of rated voltage into electrical box and leave 6" of wire length.
3. Remove exit face. To open the sign, remove screws from the end cap (See Fig. 1) and slide out the exit face and the fibreglass diffuser.
4. Remove the appropriate chevron(s) on the exit sign by supporting the exit face either side of the chevron and knock out carefully with a screwdriver from the rear (See Fig. 2).

Wall Mount

- a. Knock out the proper hole pattern in the back plate to mount to the standard junction box (including the large wire hole); place a support on either side of the hole to be removed and knock out with a screwdriver.
- b. Feed AC supply leads through the center hole.
- c. Mount the exit sign securely to the junction box using the junction box screws (See Fig. 3).

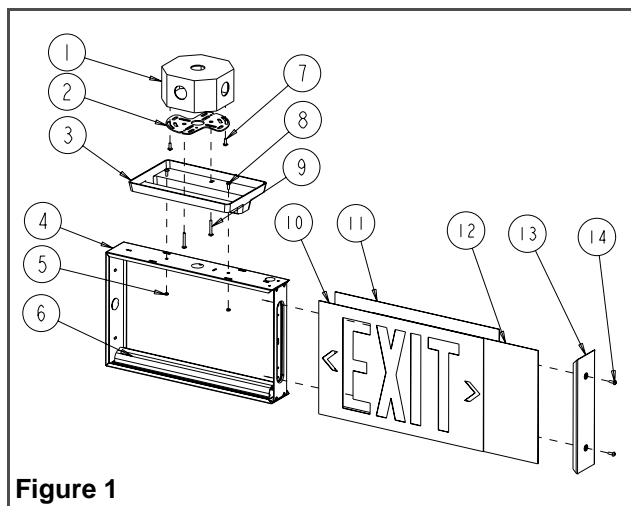

Figure 1

Part List

- | | |
|---------------------------------------|--------------------------------------|
| 1. Junction box (existing) | 8. Screws #8-32 x 3/8" (2) |
| 2. Spider Plate | 9. Screws #8-32 x 1-1/2" (2) |
| 3. Canopy | 10. Exit face |
| 4. Housing | 11. Back Plate (or second exit face) |
| 5. Kep Nuts (2) | 12. Diffuser Panel |
| 6. LED Strip | 13. End Cap |
| 7. Junction box screws (not provided) | 14. End cap screws (2) |

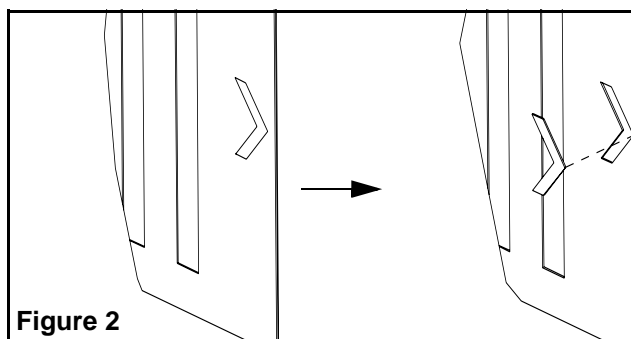

Figure 2

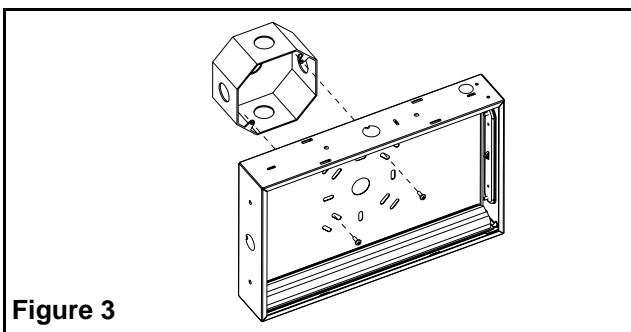
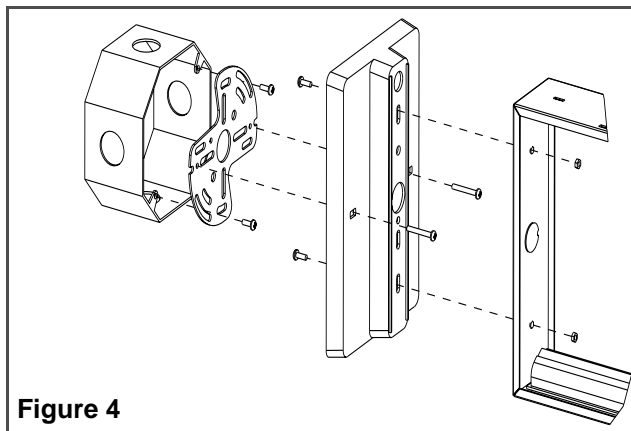

Figure 3

Canopy - Ceiling or End mount

- Determine desired mounting location of sign.
- Route AC wires from exit through large knockout. For ceiling mount, make sure backplate is mounted so exit face will be facing in desired direction.
- Fasten the spider plate to the junction box using the junction box screws. Align the two threaded holes in the spider plate to line up with the canopy holes for correct mounting position, end or ceiling.
- Fasten the canopy to the exit using #8-32 x 3/8" screws and kep nuts provided (See Fig. 4)
- Fasten the canopy-exit assembly to the spider plate using the #8-32 x 3/4" screws provided.

Figure 4
Electrical connection (LED models only)

- Make the proper connections, our system accepts an input voltage of 120 to 350 VAC (see fig. 5). Connect the (120 to 350 VAC) and white (Neutral) leads to the building utility. Feed excess wire into the junction box. For remote power DC units, connect the red wire to the positive of the DC supply and the blue to the negative (6 to 24VDC).
- Connect the green ground wire to the service ground or the ground connection in the junction box.
- When ready to energize AC, plug in battery connector to circuit board. Connect battery and turn on AC power within 6 hours.
- Turn on AC supply. LED strip will light and red pilot light will illuminate. Allow 24 hours charge before initial duration testing.
- Slide the diffuser panel, exit face and back plate, if removed, into the housing. Secure end cap with the appropriate screws.
- AC must be ON while battery is connected.

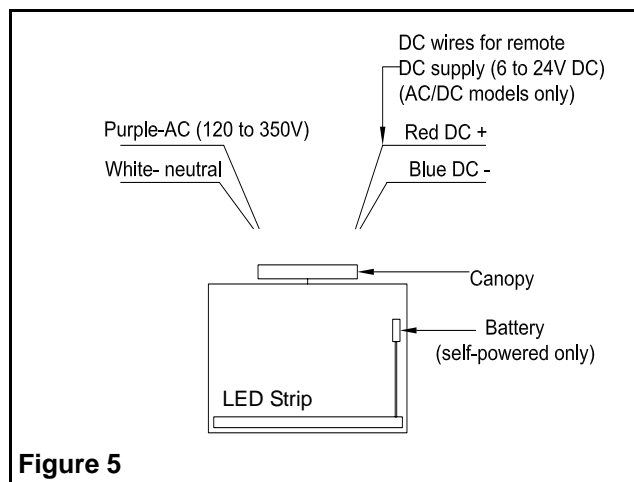
Figure 5
Electrical connection (Incandescent models only)

- Connect wires, 120VAC to black and Neutral to white. Push the wirenuts back into the junction box and route wires as far away from the lamps as possible to avoid shadows or damage to the insulation.
- Install AC lamps.
- Turn on AC supply.
- Slide the diffuser panel, exit face and back plate, if removed, into the housing. Secure end cap with the appropriate screws.

Testing

Operate test switch, LED strip will brighten. Release test switch, LED strip will dim and pilot light will be illuminated. If LED strip appears dim or does not light on test, leave AC connected for at least 15 minutes and re-test. If still incorrect, contact a serviceman or the factory for assistance.

Maintenance

None required. Unit should be tested monthly in accordance with safety codes and local codes. If AC supply to the unit is to be disconnected for 2 months or more, the battery must be disconnected.

X4 Sreies- All steel construction Exit Sign

Power Pack LED Series

IMPORTANT SAFEGUARDS

When using electrical equipment, basic safety precautions should always be followed including the following:

READ AND FOLLOW ALL SAFETY INSTRUCTIONS

1. Do not use outdoors.
2. Do not let power supply cords touch hot surfaces.
3. Do not mount near gas or electric heaters.
4. Use caution when handling batteries. Avoid possible shorting.
5. Equipment should be mounted in locations and at heights where it will not readily be subjected to tampering by unauthorized personnel.
6. The use of accessory equipment not recommended by the manufacturer may cause an unsafe condition.
7. Caution: If optional Halogen cycle lamp(s), symbol (H—), are used in this equipment, to avoid shattering: do not operate lamp in excess of rated voltage, protect lamp against abrasion and scratches and against liquids when lamp is operating, dispose of lamp with care.
8. Halogen cycle lamps operate at high temperatures. Do not store or place flammable materials near lamp.
9. Do not use this equipment for other than intended use.
10. All servicing should be performed by qualified service personnel.

SAVE THESE INSTRUCTIONS

Installation Instructions

1. Turn off AC power.
2. Route AC unswitched circuit of rated voltage into electrical box and leave 6" of wire length.
3. To open the sign, remove screws from the end cap (see fig. 1) and slide out the face plate and fiberglass diffuser.
4. Remove the appropriate chevron(s) on the exit sign by supporting the front plate either side of the chevron and knock out carefully with a screwdriver from the rear (see fig. 2).
5. Follow the proper mounting solution (end or canopy mount) and continue to step 6.

Wall Mount

- a. Knock out the proper hole pattern in the back plate to mount to the standard junction box; place a support either side of the hole to be removed, and knock out with a screwdriver.
- b. Feed AC supply leads through the center hole.
- c. Mount the exit sign securely to the junction box using the junction box screws (see fig. 3). Continue to step 6.

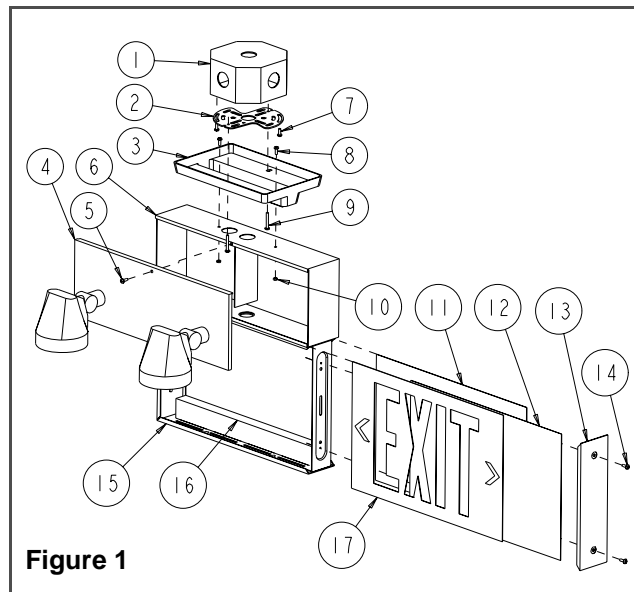

Figure 1

Part List

- | | |
|---------------------------------------|----------------------------|
| 1. Junction box (not provided) | 9. Screws #8-32 x 3/4" (2) |
| 2. Spider plate | 10. Kep Nuts (2) |
| 3. Canopy | 11. Back Plate |
| 4. Power Pack cover | 12. Fiberglass Diffuser |
| 5. Power Pack cover screw | 13. End Cap |
| 6. Power Pack | 14. End cap screws (2) |
| 7. Junction box screws (not provided) | 15. Housing |
| 8. Screws #8-32 x 3/8" (2) | 16. LED assembly |
| | 17. Face plate |

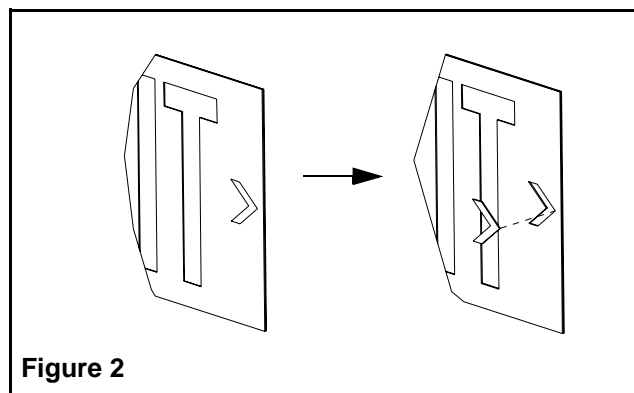

Figure 2

Canopy - Ceiling or End mount

End mount installation is not recommended with the SMX, SRX and STX models; the weight of the unit is too far from the wall.

- a. Fasten the spider plate to the junction box using the junction box screws. Align the two threaded holes in the spider plate to line up with the canopy holes for correct mounting position, end or ceiling (see fig. 4).
 - b. Fasten the canopy to the exit using #8-32 x 3/8" screws and kep nuts provided (see fig. 4).
 - c. Fasten the canopy-exit assembly to the spider plate using the #8-32 x 3/4" screws provided.
6. Make the electrical connections according to the input wiring section below and figure 5. Extend ground wire in accordance with local codes.
 7. Plug the supply from the reflector/power assembly into the LED module, routing the wires away from the legend to avoid shadowing.
 8. When ready to energize AC, plug polarized battery connector in top power pack into the PCB.
 9. Turn ON AC service. The LED strip and pilot lamps will light. DC lamps on power pack (if applicable) will not.
 10. Re-install power pack cover.
 11. Slide the fiberglass diffuser and face plate into the housing. Secure the end cap with the appropriate screws.

AC Input wiring

For 120 VAC Operation

Connect the black (120 VAC) and white (neutral) leads to the building utility. Insulate orange wire (see fig. 5).

For 277 VAC Operation

Connect the orange (277 VAC) and white (Neutral) leads to the building utility. Insulate black wire (See fig. 5).

Testing

Operate test switch (see fig. 6). Sign will brighten and head lamps (if applicable) will illuminate. Release test switch, lamps will extinguish, sign will dim and both pilot lamps will illuminate. Red pilot lamp will pulse in increasing intervals. If it remains on continuously after 24 hours there is a malfunction. Contact a serviceman or the factory.

Maintenance

None required. Unit should be tested monthly in accordance with the Life Safety Code, NFPA 101 and local codes.

This equipment is furnished with a low battery disconnect circuit in emergency mode. If AC supply to the unit is to be disconnected for 2 months or more, the battery must be disconnected. Do not allow battery wires to short circuit.

Note — Nickel Cadmium battery units are shipped discharged and may require 10 minutes of connection to AC supply before start-up test procedure, and 96 hours to reach full charge.

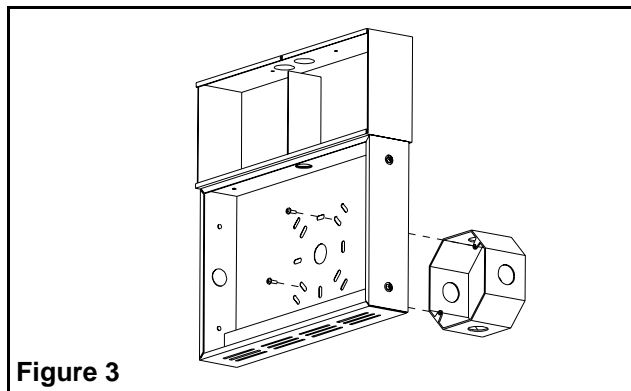

Figure 3

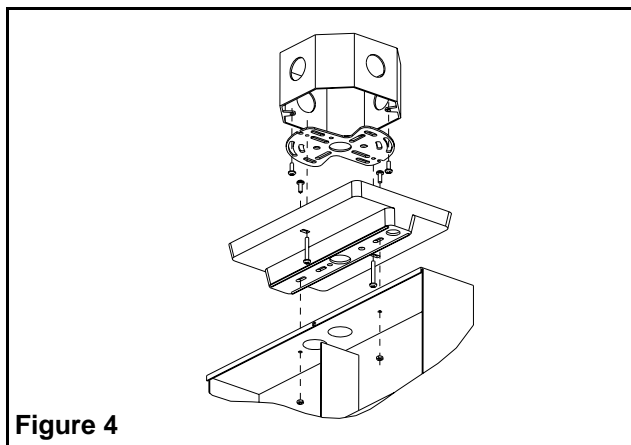

Figure 4

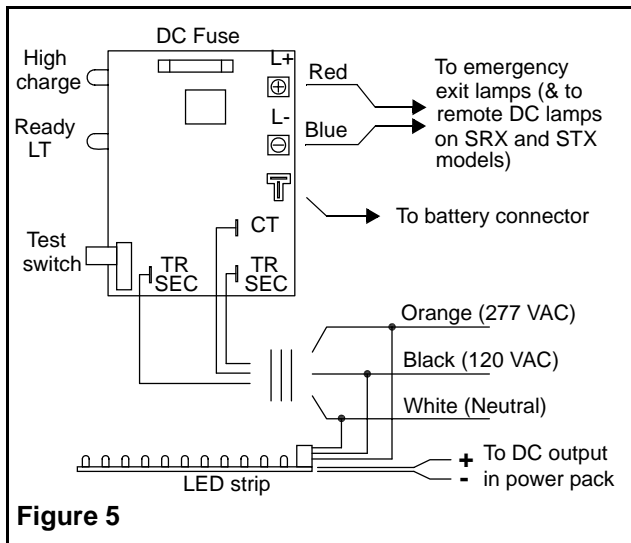

Figure 5

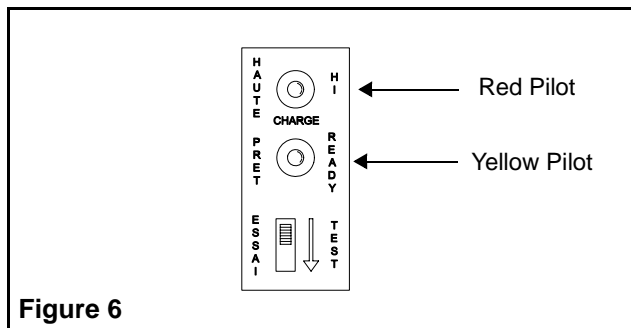

Figure 6